



## OVERVIEW



*Situated amid 200 acres on Southern California's sun-drenched Pacific Coast, Park Hyatt Aviara Resort is a coastal resort located in Carlsbad, north of downtown San Diego. Surrounded by natural beauty and tranquility, the resort is perched atop a high ridge on the shore of Batiquitos Lagoon, a beautiful wildlife sanctuary overlooking the Pacific Ocean.*

### ACCOMMODATION

- 327 guestrooms, including 43 suites all with a balcony or patio, 250 kings, 77 king/king and 10 accessible rooms
- Forbes Five Star 2015-2020
- AAA Five Diamond- 2000-2020
- 100% smoke free environment

All accommodations offer:

- Luxurious pillow-top beds
- Wired and wireless Internet
- 55" Plasma TVs with Over 150 Channels including Premium Networks, Movies, Entertainment and More
- 48 Sports Channels including NBA-NFL-MLB-NHL Networks, NFL Redzone and more!
- Chromecast Video Streaming to personalize your programming
- Digital Newspaper & Magazines offering 7,000+ Titles & Publications
- In-Room Bose Stereo
- Cordless telephone with voicemail
- Video messages, video account review, video checkout
- In-room safe deposit box
- Turndown service
- Deluxe Le Labo bath toiletries and two robes
- Illy Espresso Maker
- Premium In-room Tea & Kettle
- In-Room Refrigerator

### SERVICES & FACILITIES

- 24-hour In-room dining
- Concierge
- Babies Travel Lite and babysitting services
- Assistive listening devices
- Laundry/ Dry Cleaning
- Valet parking in covered parking garage
- 24-hour security
- Overnight shoe shine
- 24-hour game room
- Daily Fitness Classes

### RESTAURANTS & BARS

- Ember & Rye—located at Aviara Golf Club featuring vintage steaks and fresh seafood with acclaimed celebrity Chef Richard Blais
- Waters' Edge—relax poolside and enjoy creative twists on American specialties
- Pacific Point—evening cocktails, light fare, tapas and live entertainment
- Ponto Lago—Baja-inspired cuisine and specialty cocktails composed of mezcal and tequila featuring a Chef's show kitchen
- All restaurants offer outdoor dining

### CONFERENCES & BANQUETS

- 83,000 square feet of event space, that features 40,000 of indoor space on two levels including the 11,730 square-foot Grand Ballroom
- 23 meeting rooms
- Scenic outdoor venues including, The Gardens, several outdoor terraces, and event lawn that can hold from 10-1,000 guests
- Wired and wireless high-speed Internet access
- On-site audiovisual company and technicians

### RECREATIONAL FACILITIES

- Former home of the LPGA Kia Classic Golf Tournament, our Arnold Palmer-designed golf course is complemented by a practice range, putting and pitching greens, industry-leading GPS systems on all golf carts, and an upscale golf shop.
- Miraval Life in Balance Spa--An oasis with treatment rooms, a romantic couples suite, and an indoor solarium lounge; locker rooms feature aromatic steam rooms, saunas, and whirlpools.
- Fitness Center— 24 hours, featuring the very best in cardio and fitness equipment
- Park Hyatt Aviara Tennis Court & Recreational Facility— Four hard and two clay courts amidst a botanical setting, and complemented by a Peter Burwash International instructional program
- Local Activities— helicopter tours, hiking, hot air ballooning, para-gliding / hang-gliding, wine tasting, Batiquitos Lagoon trail, craft brewery tours, stand-up paddle boarding
- Local Watersports— deep sea fishing, kayaking, sailing, scuba diving, snorkeling, surfing, whale watching, wakeboarding, kite surfing
- Two sparkling pools, one for adults and one for families
- Guitars — Add a little music to your stay with complimentary usage of a Martin Guitar. Reserve with Concierge.

### POINTS OF INTEREST

- Carlsbad Beaches
- LEGOLAND®
- Carlsbad Premium Outlets
- Del Mar Racetrack
- The Forum Shops
- Cedros Design District
- San Diego Zoo®
- SeaWorld®
- San Diego Safari Park
- Gaslamp District
- Balboa Park
- Temecula Wine Country
- Petco Park
- SDCCU Stadium
- San Diego Botanic Gardens
- USS Midway Museum

7100 Aviara Resort Drive  
Carlsbad, CA 92011 USA  
aviara.park.hyatt.com

T. +1 760 448 1234  
F. +1 760 603 6801  
[Link to map](#)

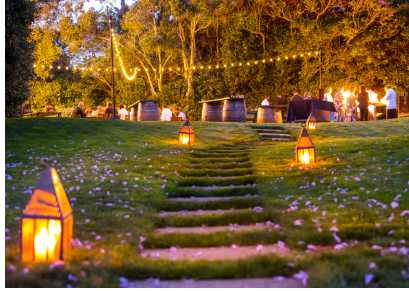

## ROOM DIMENSIONS & CAPACITIES

ROOM NAME	ROOM DIMENSIONS L x W x H	SQUARE FEET	BANQUET	RECEPTION	THEATER	CLASSROOM	BOARDROOM	U-SHAPE	HOLLOW SHAPE
FIRST FLOOR – TERRACE LEVEL									
Avalon	87' x 39' x 12'	3,456	210	390	320	195	76	78	90
Avalon A	46' x 40' x 12'	1,817	120	210	160	108	40	45	60
Avalon B	42' x 40' x 12'	1,639	90	180	160	90	34	39	54
Avalon Foyer	87' x 15' x 12'	1,356	60	190	—	—	—	—	—
Avalon Terrace	66' x 90'	2,970	140	200	—	—	—	—	—
Laviana	73' x 36' x 12'	2,591	160	290	238	141	58	63	72
Laviana A	43' x 33' x 12'	1,402	80	145	126	82	34	33	42
Laviana B	30' x 35' x 12'	1,082	50	125	98	58	28	27	36
Laviana Terrace	99' x 57'	2,821	90	180	—	—	—	—	—
Kingfisher	38' x 56' x 12'	2,184	130	250	212	120	—	51	66
Kingfisher A	39' x 29' x 12'	1,102	60	120	80	72	28	33	42
Kingfisher B	39' x 29' x 12'	1,102	60	120	80	72	28	33	42
Filliary	42' x 24' x 12'	610	20	80	38	24	18	15	18
Filliary Terrace	16' x 11'	194	—	10	—	—	—	—	—
Mariposa	—	—	130	200	280	140	48	60	54
Mariposa A	49'3" x 26'9" x 12'	1,317	80	120	168	81	36	42	48
Mariposa B	57'10" x 19'6" x 12'	1,217	50	80	120	66	48	48	48
Mariposa Terrace	20'6" x 58'6" x 12'	1,200	60	80	—	—	—	—	—
OUTDOOR SPACE									
The Gardens	—	17,205	1,230	1,910	1,720	—	—	—	—
Palm Garden	105' x 21'	2,247	160	250	225	—	—	—	—
Palm Court	119' x 22'	2,618	190	290	260	—	—	—	—
Park Lawn	107' x 81'	8,614	620	960	860	—	—	—	—
Fountain Terrace	46' x 81'	3,726	270	415	370	—	—	—	—
Heron Lawn	—	—	1,500	2,000	—	—	—	—	—
Green Heron Lawn	—	—	—	—	—	—	—	—	—
White Heron Lawn	—	—	—	—	—	—	—	—	—
Palmer Pavilion	—	1,500	70	100	154	—	—	—	—

7100 Aviara Resort Drive  
 Carlsbad, CA 92011 USA  
 aviara.park.hyatt.com

T. +1 760 448 1234  
 F. +1 760 603 6801  
[Link to map](#)



## ROOM DIMENSIONS & CAPACITIES

ROOM NAME	ROOM DIMENSIONS L x W x H	SQUARE FEET	BANQUET	RECEPTION	THEATER	CLASSROOM	BOARDROOM	U-SHAPE	HOLLOW SHAPE
THIRD FLOOR – LOBBY LEVEL									
Grand Ballroom	89' x 133' x 18'	11,730	840	1,200	1,000	828	—	—	—
Grand Ballroom ABC	89' x 88' x 18'	7,744	560	900	860	544	—	102	138
Grand Ballroom A	89' x 44' x 18'	3,898	210	400	306	234	—	81	96
Grand Ballroom B	89' x 22' x 18'	1,949	—	—	—	—	—	—	—
Grand Ballroom C	89' x 22' x 18'	1,949	—	—	—	—	—	—	—
Grand Ballroom D	89' x 44' x 18'	3,898	210	400	306	234	—	81	96
Grand Ballroom AB	89' x 66' x 18'	5,808	336	600	650	360	—	93	120
Grand Ballroom BC	89' x 44' x 18'	3,872	180	380	320	180	—	66	78
Grand Ballroom CD	89' x 66' x 18'	5,808	336	600	650	360	—	66	78
Grand Ballroom BCD	89' x 88' x 18'	7,744	560	900	860	544	—	102	138
Grand Foyer	38' x 91' x 13.2'	3,480	—	475	—	—	—	—	—
Grand Foyer A	38' x 46' x 13.2'	1,740	—	237	—	—	—	—	—
Grand Foyer B	38' x 46' x 13.2'	1,740	—	237	—	—	—	—	—
Aviara Salon	50' x 75' x 14.5'	3,800	240	500	380	234	—	72	90
Aviara A	50' x 38' x 14.5'	1,900	120	250	160	108	—	48	54
Aviara B	50' x 38' x 14.5'	1,900	120	250	160	108	46	48	54
Aviara Foyer	21' x 61' x 12.1'	1,283	50	160	—	—	46	—	—
Aviara Promenade	23' x 32' x 12.1'	512	—	40	—	—	—	—	—
Aviara Courtyard	31' x 48' x 12.1'	1,488	60	180	—	—	—	—	—
Aviara Terrace	44' x 39'	572	20	40	—	—	—	—	—
California Salon	—	4,064	200	200	—	—	—	—	—
California Salom Terrace	—	1,380	100	130	—	—	—	—	—
Blue Heron	23' x 32' x 13.5'	736	40	65	56	30	28	24	30
Blue Heron Terrace	14' x 24'	336	10	25	—	—	—	—	—
Goldfinch	19' x 27' x 12.6'	513	20	40	40	18	20	18	24
Goldfinch Terrace	13' x 36'	432	16	30	—	—	—	—	—
Avocet	33' x 48' x 12.6'	1,632	110	130	120	96	40	42	54
Avocet Terrace	19' x 50'	918	40	65	—	—	—	—	—
Osprey	21' x 25' x 15'	546	20	40	40	30	22	18	24
Osprey Terrace	18' x 28'	504	10	35	—	—	—	—	—
Egret	20' x 26' x 12.3'	525	20	40	40	30	18	18	24
Pelican	17' x 25' x 12.3'	450	—	—	—	—	20	—	—

7100 Aviara Resort Drive  
 Carlsbad, CA 92011 USA  
 aviara.park.hyatt.com

T. +1 760 448 1234  
 F. +1 760 603 6801  
[Link to map](#)



## ROOM DIMENSIONS & CAPACITIES

ROOM NAME	ROOM DIMENSIONS L x W x H	SQUARE FEET	BANQUET	RECEPTION	THEATER	CLASSROOM	BOARDROOM	U-SHAPE	HOLLOW SHAPE
THIRD FLOOR – LOBBY LEVEL									
Nest (Office)	11'4" x 16'3" x 18'	184	—	—	20	—	30	—	—
Sanctuary (Office)	10' x 24' x 18'	240	—	—	—	—	5	—	—
Reserve (Office)	23'7" x 12'6" x 18'	253	—	—	30	—	—	—	—
Haven (Office)	9'11" x 10'9" x 18'	107	—	—	15	—	—	—	—
Falcon	9'4" x 11'5" x 18'	107	—	—	15	—	—	—	—
Hawk	7'3" x 44' x 18'	65	—	—	10	—	—	—	—

7100 Aviara Resort Drive  
Carlsbad, CA 92011 USA  
aviara.park.hyatt.com

T. +1 760 448 1234  
F. +1 760 603 6801  
[Link to map](#)



## FLOOR PLAN

### FIRST FLOOR – TERRACE LEVEL

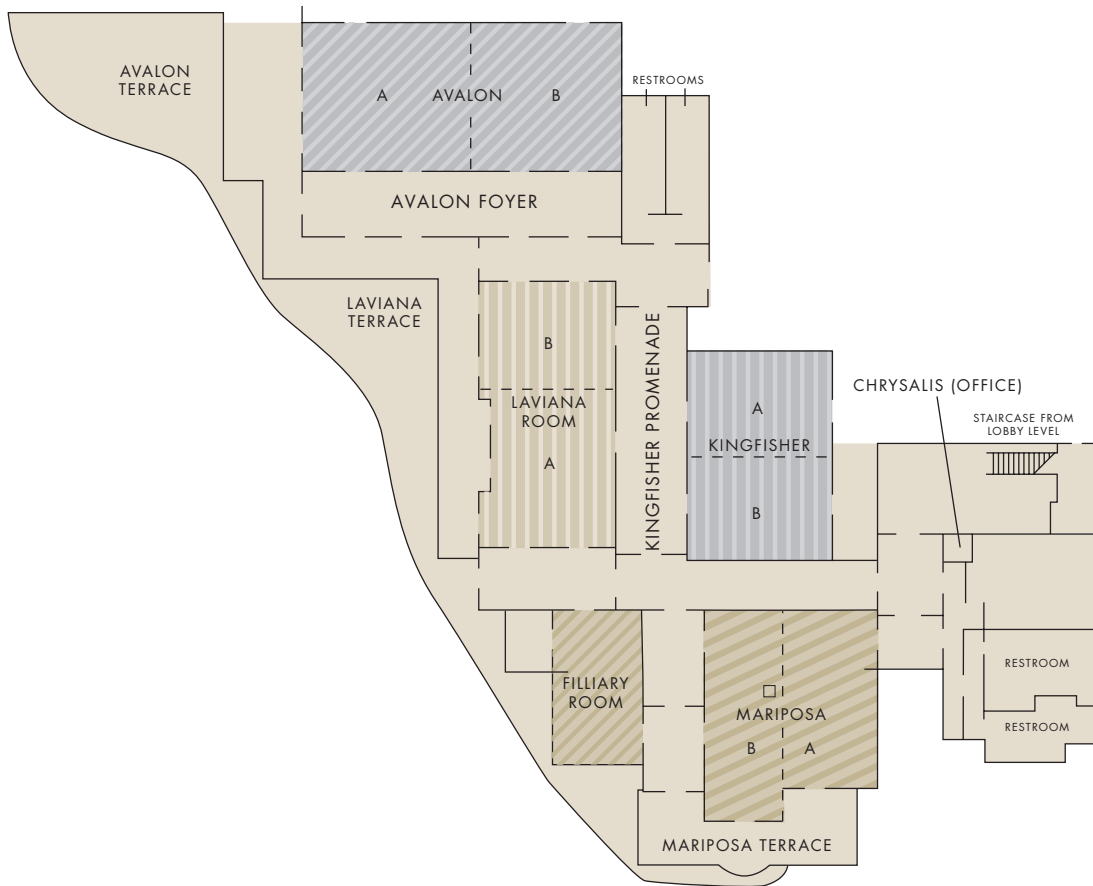

7100 Aviara Resort Drive  
 Carlsbad, CA 92011 USA  
 aviara.park.hyatt.com

T. +1 760 448 1234  
 F. +1 760 603 6801  
[Link to map](#)



FLOOR PLAN

THIRD FLOOR – LOBBY LEVEL

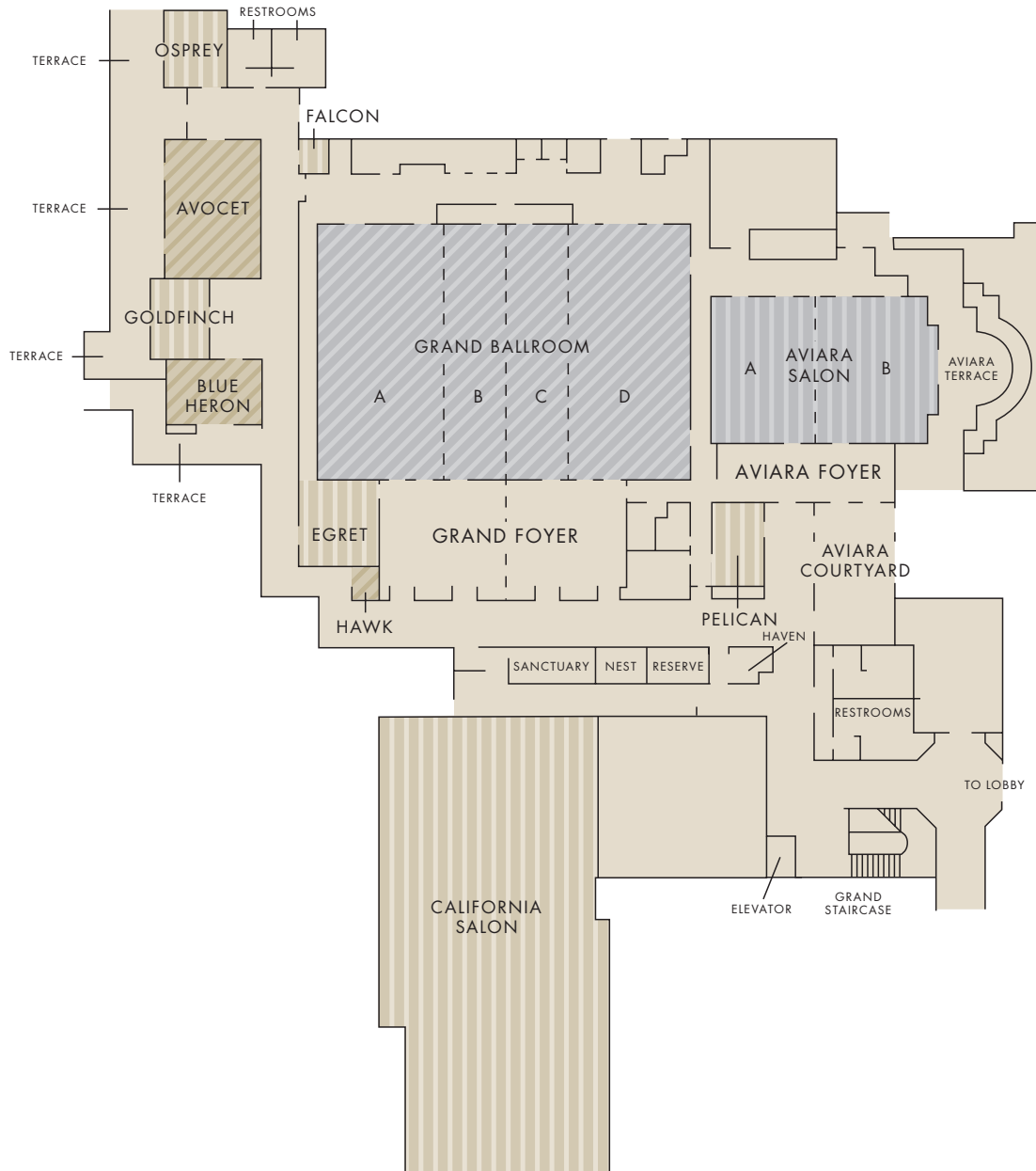

7100 Aviara Resort Drive  
 Carlsbad, CA 92011 USA  
 aviara.park.hyatt.com

T. +1 760 448 1234  
 F. +1 760 603 6801  
[Link to map](#)



## FLOOR PLAN

### THE GARDENS

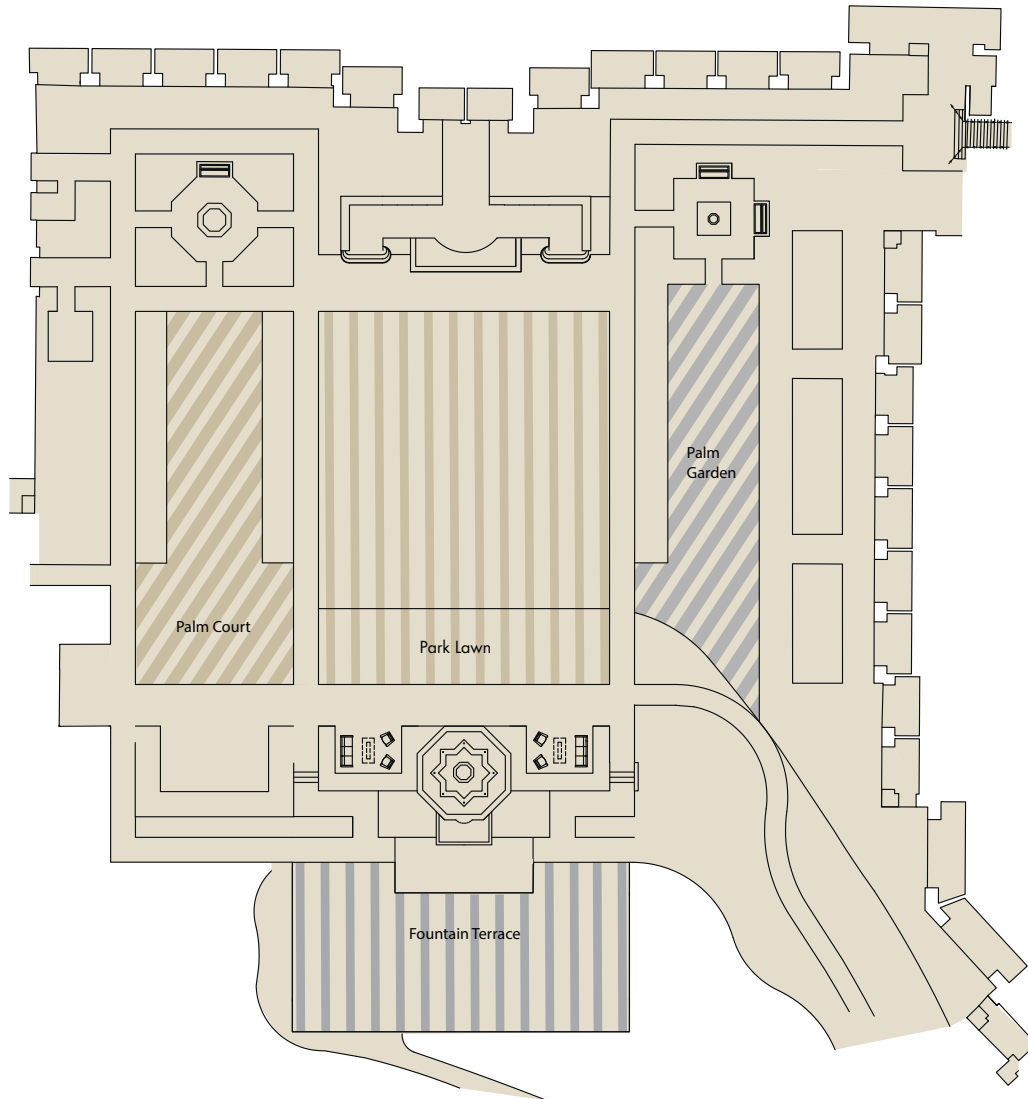

7100 Aviara Resort Drive  
Carlsbad, CA 92011 USA  
aviara.park.hyatt.com

T. +1 760 448 1234  
F. +1 760 603 6801  
[Link to map](#)

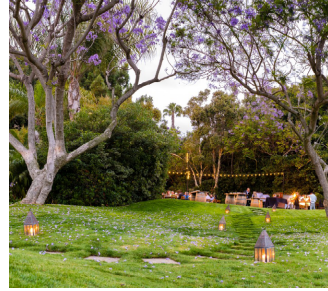

PARK HYATT®

## DIRECTIONS

SAN DIEGO INT'L AIRPORT (SAN) – 32 miles / 35 minutes

MCCLELLAN-PALOMAR AIRPORT (CLD) – 3 miles / 10 minutes

ORANGE COUNTY AIRPORT (SNA) – 55 miles / 90 minutes

LOS ANGELES INT'L AIRPORT (LAX) – 95 miles / 2 hours



7100 Aviara Resort Drive  
Carlsbad, CA 92011 USA  
aviara.park.hyatt.com

T. +1 760 448 1234  
F. +1 760 603 6801  
[Link to map](#)